



BIG SKY
INTERIOR DESIGN

BRUNSWICK COUNTY COURTHOUSE
DESIGN PRESENTATION
2021

NEW FURNITURE

CENTER ARMS NOT INCLUDED

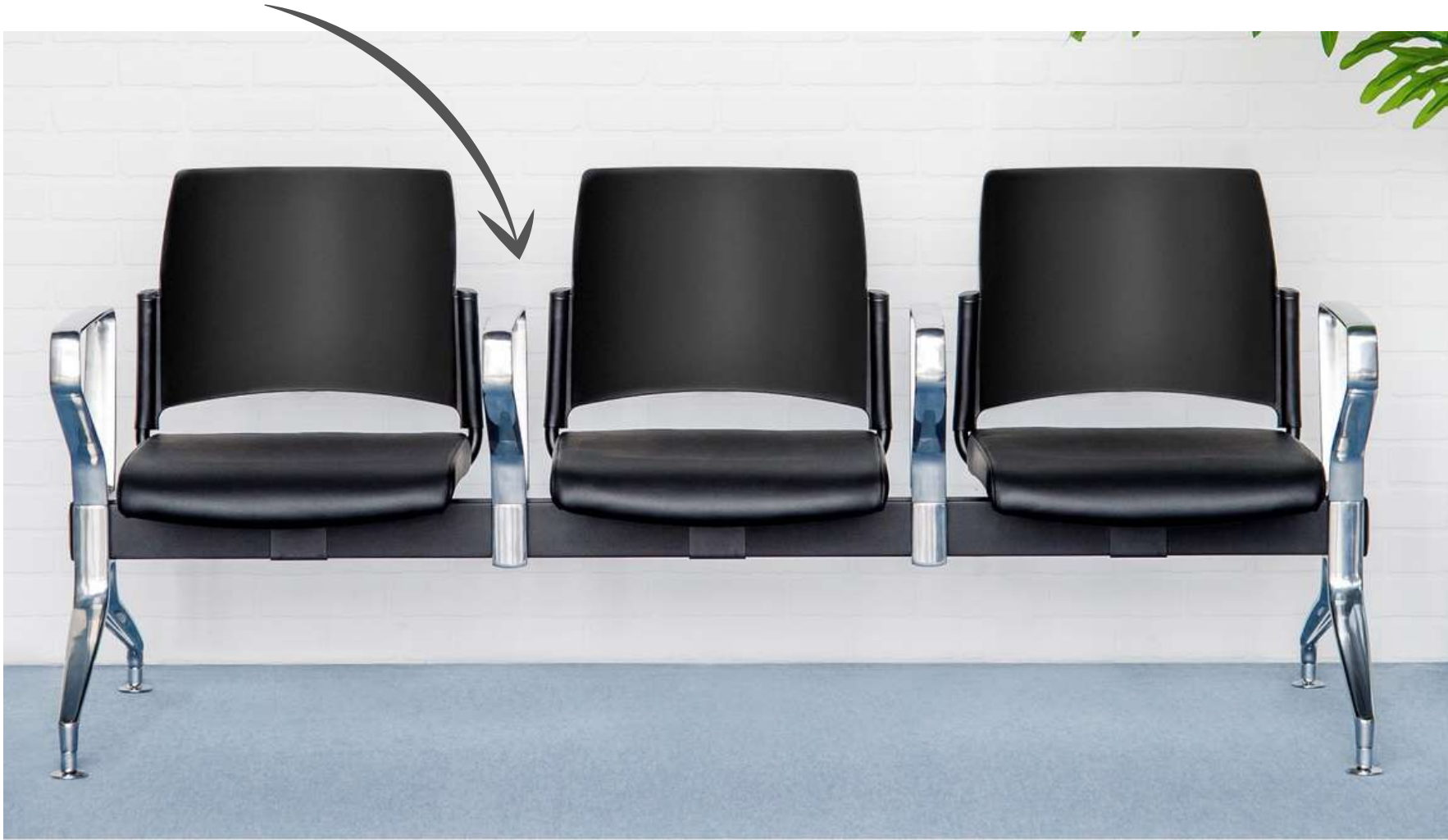

3-SEATER
ROUILLARD- MIA
POLY SEAT + BACK



JUDGE'S CHAIR
NATIONAL- ELOQUENCE



ATTORNEY CHAIR
NATIONAL- TRIUMPH



JURY CHAIR
NATIONAL- TRIUMPH



SPECTATOR CHAIR
ALLSEATING- INERTIA MESH BACK, CUSHION SEAT

CUSTOM ATTORNEY TABLES
MILLWORK TO MATCH JUDGE'S BENCH, WITNESS
STAND + JUDGE'S CLERK AREA

*PHOTO NOT SHOWN



TASK CHAIR
ALLSEATING- ENTAIL



CURRENT CLAMP-ON POWER



WORKING TABLES W/ MODESTY PANEL
NATIONAL- WAVEWORKS



JURY CHAIRS
SAFCO- VALORE

PLASTIC BACK WITH PADDED SEAT



SEATING
SIT ON IT- RIO



EXISTING JURY CHAIRS
REUSING ~85, REMAINING REUSED THROUGHOUT 2ND FLOOR

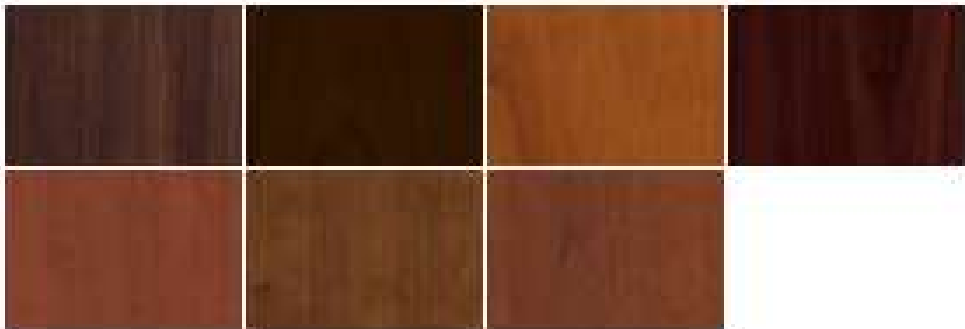

Phoenix Casegoods

Technical Specifications

Construction & Materials

Veneer:	Exposed surfaces feature select grade, plain sliced American Black Walnut and Cherry hardwood veneers, carefully selected and matched to assure proper balance and consistency. Multi-step, hand finishing process on all exposed wood frames, and feature a catalyzed varnish finish which offers durability, lasting beauty, and resistance to normal wear.
Laminate:	High-Pressure Laminate (HPL) tops are made of woodgrain laminates fused to particleboard core. Each laminate offers lasting beauty, superior resistance to normal wear, and easy maintenance.
Tops:	1 3/4" thick. Wood Veneer worksurfaces are 5-ply balanced construction with solid hardwood rims. HPL worksurfaces are 3-ply balanced construction with solid hardwood rims. Grain direction runs left to right, unless otherwise noted.
Chassis:	Veneer Chassis is constructed of American Black Walnut or Cherry hardwood veneer. Chassis is securely fastened using high quality European fastening systems and heavy-duty, 16-gauge joining brackets to assure maximum strength. Units feature finished backs, unless otherwise noted. All units ship with heavy-duty, adjustable leveling glides to ensure proper leveling and compensation for uneven floors.
Drawers:	Box and file drawers are tested for 100lb capacity. Lateral files are tested for 200lb capacity. 5-sided drawer construction for easy removal of drawer fronts. Drawer fronts are 3-ply construction, 3/4" thick with matched grain while sides, back, and front are 1/2" thick woodgrain vinyl-wrapped miter fold construction. Box and file drawers have 1/2" thick hardboard bottoms, while lateral file drawers feature 1/2" thick bottoms. Box and file drawers have full extension, progressive action slides with precision steel ball bearings. All suspensions have a limited lifetime warranty.
Filing:	All file drawers are standard with filing systems designed to accommodate a variety of filing requirements. Legal and letter width file drawers provide legal front to back, and letter or legal side to side.
Storage:	All hinged doors include soft close hinges. Soft close hinges reduce stress placed on the cabinet when the door is closed and offers a quiet closure.
Locking:	All desks, credenzas, returns, and files feature standard locking. Lock core is available in black or silver. Removable lock cylinders allow for units to be re-keyed at a later date if required. Units are shipped randomly keyed as standard. Keyed alike units available upon request at no additional charge.
Cord Mgmt:	Grommets are standard in back panels of assembled returns, bridge units, kneespace credenzas, and hutch units. A grommet is standard in tops of corner units. Grommets may be ordered in the tops of desks, returns, bridge units, credenzas, and component worksurfaces and are available in black or silver. Undersurface tracks are available for additional cord management.

Features

- Crafted in select solids and American veneers, Phoenix's clean, transitional styling is at ease in both contemporary and traditional settings. It is a perfect choice for value-minded companies who want a sophisticated, yet uncomplicated, furniture solution.
- Combining new and old in a careful balance allows Phoenix to achieve both functional and timeless beauty. Offer a broad range of interiors with veneer or laminate worksurfaces; an ample selection of storage components, coordinating tables, and accessories to fully equip personal and shared work spaces.
- Phoenix features a veneer chassis with your choice of either a veneer or HPL top.
- Storage and table elements, like credenzas, bookcases, wardrobes, and occasional tables, are available to complete an office or easily work on their own in a variety of applications.
- The optional center drawer with pencil tray offers additional and convenient storage to keep desk tops clutter free.
- Route power and data cables away from desktop for clutter-free workspaces. Grommets are standard in back panels of returns, bridges, credenzas, and hutch units. Silver grommets are available.
- A holistic surface materials palette, featuring veneer finishes, woodgrain laminates, and more.
- 12 Year Warranty (some exclusions may apply; see Full Warranty in Price List).
- Units ship fully assembled.

Certifications & Compliance

- ETL Environmental Certification for compliance with VOC emission concentrations
- BIFMA level® Certified for environmentally-preferable and socially-responsible office furniture
- BIFMA Compliant® Certified for meeting mechanical standards that focus on safety and durability
- TSCA Title VI (Formerly CARB) Compliance
- Contribution to U.S. Green Building Council's LEED Program



Indiana
FURNITURE
www.IndianaFurniture.com



Canvas Casegoods

Technical Specifications

Construction & Materials	
Laminate:	Thermally Fused Laminate (TFL) and High Pressure Laminate (HPL) are made of solid colors and woodgrain laminates fused to particleboard core. Each laminate offers lasting beauty, superior resistance to normal wear, and easy maintenance.
Top:	1" thick TFL or HPL with 3mm matching PVC rims contoured to selected profile and 3mm PVC rims on self edges. Grain direction runs left-to-right, unless otherwise noted. 1/8" thick tops in HPL are available upon request.
Chassis:	Chassis are fastened by using high quality Euro-style fastening systems to ensure maximum strength. All units ship with heavy-duty, adjustable glides to ensure proper leveling and compensation for uneven floors.
Drawers:	All drawer fronts are standard with woodgrain or solid color faces. Drawers feature 5-sided construction with 1/2" 3-ply fronts, 1/2" thick hardwood sides and 1/2" hardboard bottoms. Units with 36" wide file drawers feature 1/2" thick drawer bottoms for maximum storage strength. Drawer interiors are sanded, sealed, and finished to provide for a smooth, quality feel and appearance. All drawers feature full extension, progressive action glides with precision steel ball bearings. Box and file drawers are tested for 100lb capacity while lateral files are tested for 200lb capacity. All supervisors have a limited lifetime warranty.
Storage:	All hinged doors include soft close hinges. Soft close hinges reduce stress placed on the cabinet when the door is closed and offers a quiet closure.
Locking:	All units with file drawers feature standard locking. Lock core available in black or silver. Removable lock cylinders allow for units to be re-keyed at a later date if required. Units are shipped randomly keyed as standard. Keyed alike units are available upon request at no additional charge.

- Features**
- Canvas Casegoods Collection delivers environments with refined aesthetics born from an appealing mix of materials, finishes and components.
 - Elevate the style of any space with integrated adjustable height and boutique style shelving components, landing tables, soft close doors, metal and acrylic cabinet and drawer details.
 - Choice of four edge profiles—double bevel, ogee, full, and square.
 - Available with a selection of 10 pulls, with a choice of aluminum, black, chrome and gold, for a combination of 22 different options.
 - Select from the full line of buffers, credenzors, cubicles, wardrobes, visual boards, lecterns and table top power centers to complete your space and maximize functionality.
 - Canvas offers distinct design details such as contrasting colored drawer fronts, modesty panels and work surfaces.
 - Change up the look of your workspace with horizontal woodgrain options on door and drawer fronts.
 - Wood glaze full drawer construction offers stronger drawer joint connections and soft close drawer options reduce stress on the unit, extends the life of the drawer and ensures a gentle close.
 - Maximize storage and get organized with surface mount or wall mount hatches that include components such as fabric or dry erase work walls.
 - Personalize your storage space with acrylic dry erase or black or white glass door options on select hutch and storage cabinet models. Add popcolor to hatches with chrome or TFL dots to keep paper work organized and your workspace clean.
 - Black and White Masker Boards come in a variety of sizes and application options to keep your site fresh and let you build on great ideas.
 - Wire management options are easy to specify to route cords away from the workspace for a clean aesthetic.
 - A host of surface materials palette—veneer finishes and woodgrain laminates—get inspiration at www.indianafurniture.com.
 - 12 Year Warranty (some exclusions may apply; see Full Warranty in Product List).

- Certifications & Compliance**
- ETL Environmental Certified for compliance with VOC emission concentrations.
 - GREENGUARD® Certified for environmental (i.e. preferable and socially responsible) office furniture.
 - BIFMA Compliant® Certified for meeting mechanical standards that focus on safety and durability.
 - TSCA Title VI (Formerly CARB) Compliance.
 - Contribution to U.S. Green Building Council's LEED® Program.

Dimensions
For a full listing of tops, bases, storage, and accessories, unit dimensions and shipping information, please see the Canvas Price List.





JUDGE'S CHAIR
NATIONAL- ELOQUENCE



TASK CHAIR
ALLSEATING- INERTIA



TASK STOOL
ALLSEATING- INERTIA



STORAGE CASE
HERMAN MILLER- TU



JUDGE'S GUEST
INDIANA- BAKERSTREET



GUEST/ SIDE CHAIR
INDIANA- GLEEM



OCCASIONAL TABLES
INDIANA- ENCOMPASS



LOUNGE SEATING + OCCASIONAL TABLES
INDIANA- BLISS + ENCOMPASS



LOUNGE CHAIR
INDIANA- BLISS



SEATING
NATIONAL- COLLETTE LOUNGE



OCCASIONAL TABLES
INDIANA- ENCOMPASS



SEATING
INDIANA- CLUTCH



TABLE
INDIANA- AURA CONFERENCE
LAMINATE WITH WOOD EDGE



SEATING
ALLSEATING- ENTAIL



TABLE
INDIANA- AURA CONFERENCE
LAMINATE WITH WOOD EDGE



SEATING
SAFCO- VALORE



TABLE
INDIANA- AURA CONFERENCE
LAMINATE WITH WOOD EDGE



SEATING
SIT ON IT- RIO



TABLE
NATIONAL- UNIVERSAL



01A Folding Arm

TASK CHAIR WITH FOLD DOWN ARM
RFM TRADEMARK

EXISTING FURNITURE- NOT REUSING

OBSERVATIONS:

DESKS:

- BROKEN HANDLES/ MISSING HANDLES
- DRAWERS DID NOT WORK/ COULD NOT CLOSE
- TAPE OR OTHER MANEUVERS TO HOLD DRAWERS IN PLACE
- TRIM MOLDING MISSING OR BROKEN OFF
- SIGNIFICANT CORNER DAMAGE OR WOOD CHIPS EXPOSED THAT CANNOT BE TOUCHED UP
- WEAR TO DESK EDGE PROFILE
- HALF OF A STANDARD TYPICAL/ INCOMPLETE DESK
- OLD LOWER RETURN/KNEE BANGER

BOOKSHELVES:

- DAMAGE/ WEAR TO WOOD
- SHELVES ARE BOWING
- DIFFERENT STYLES IN EACH DEPARTMENT/ OFFICE

TASK CHAIRS:

- SEATS/ ARMS ARE WORN
- TAPE WRAPPED AROUND TO SECURE BROKEN PARTS
- STAINS
- DIFFERENT STYLES IN EACH DEPARTMENT/ OFFICE (POTENTIAL TO RELOCATE SOME AND REUSE)

GUEST CHAIRS:

- FABRIC AND WOOD ARE WORN/ CHIPPING
- STAINS
- DIFFERENCE STYLES IN EACH DEPARTMENT/ OFFICE (POTENTIAL TO RELOCATE SOME AND REUSE)



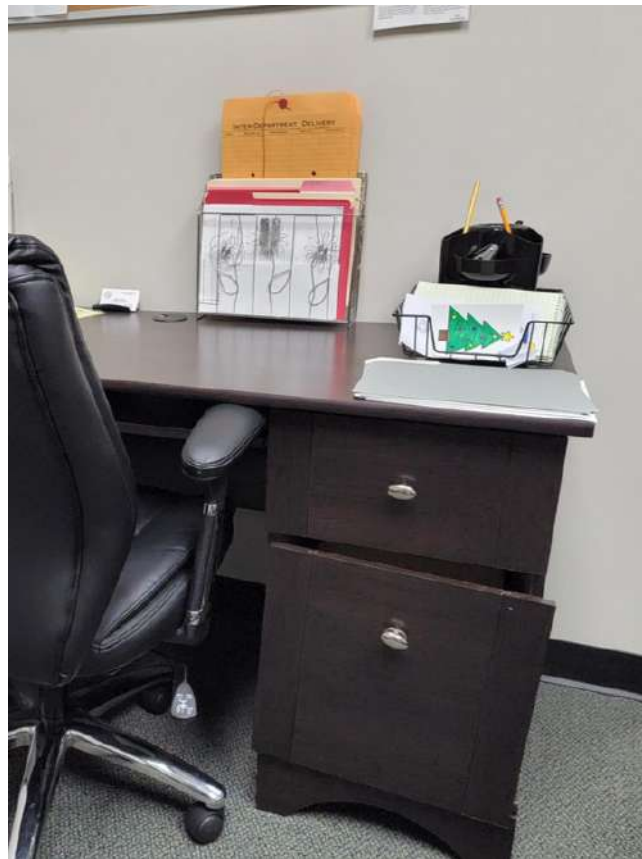
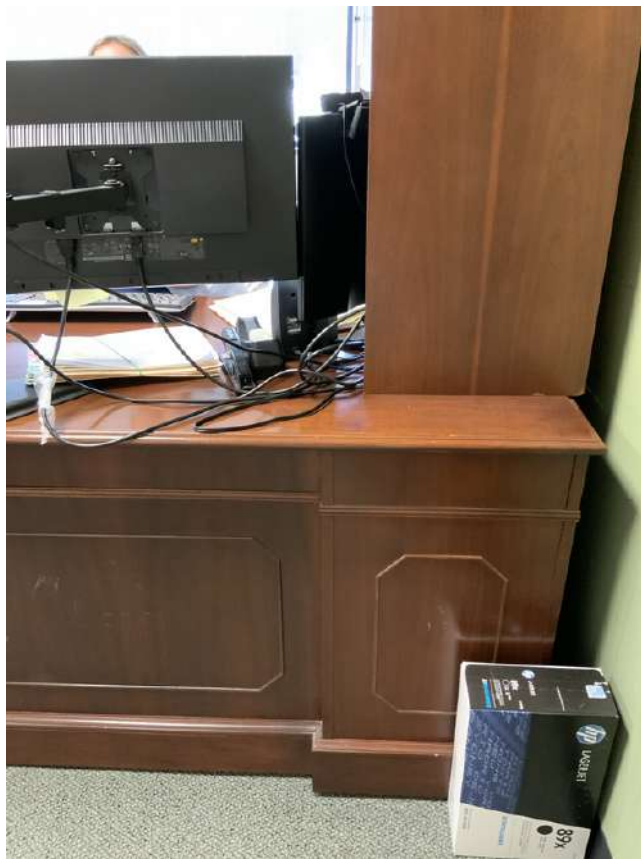

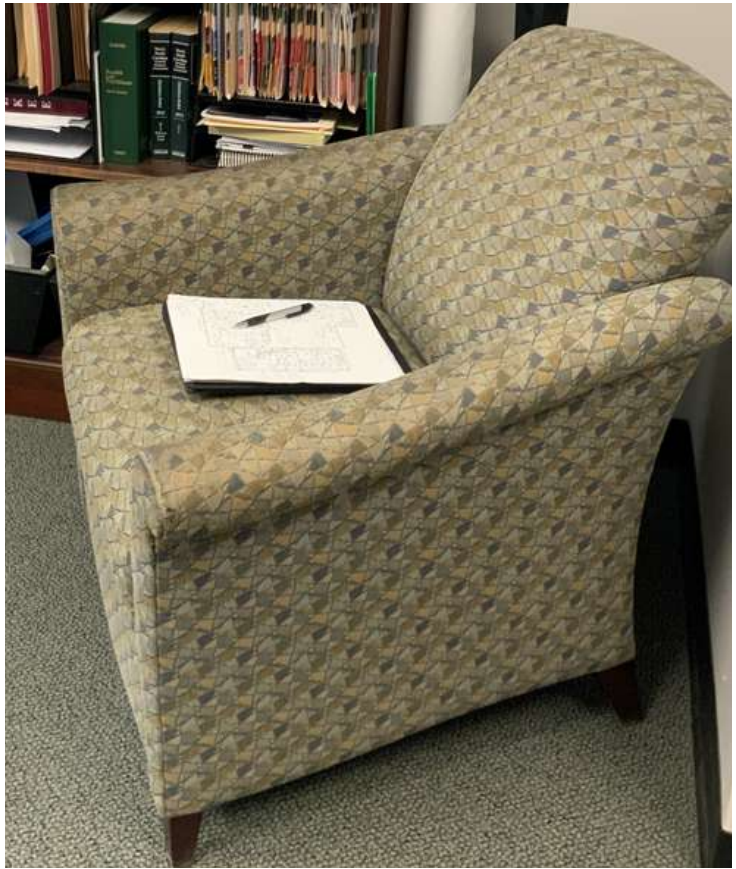

EXISTING FURNITURE- REUSING

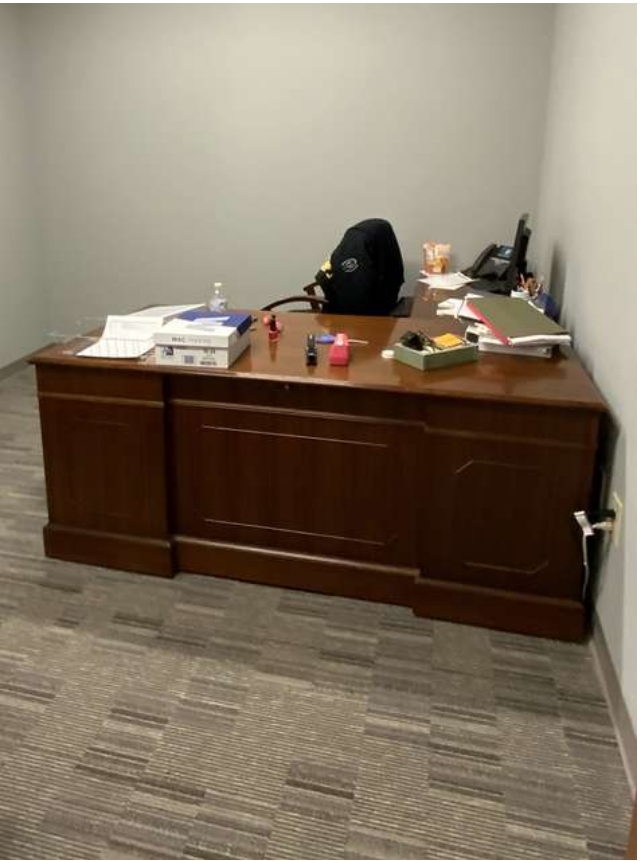



FURNITURE PLANS

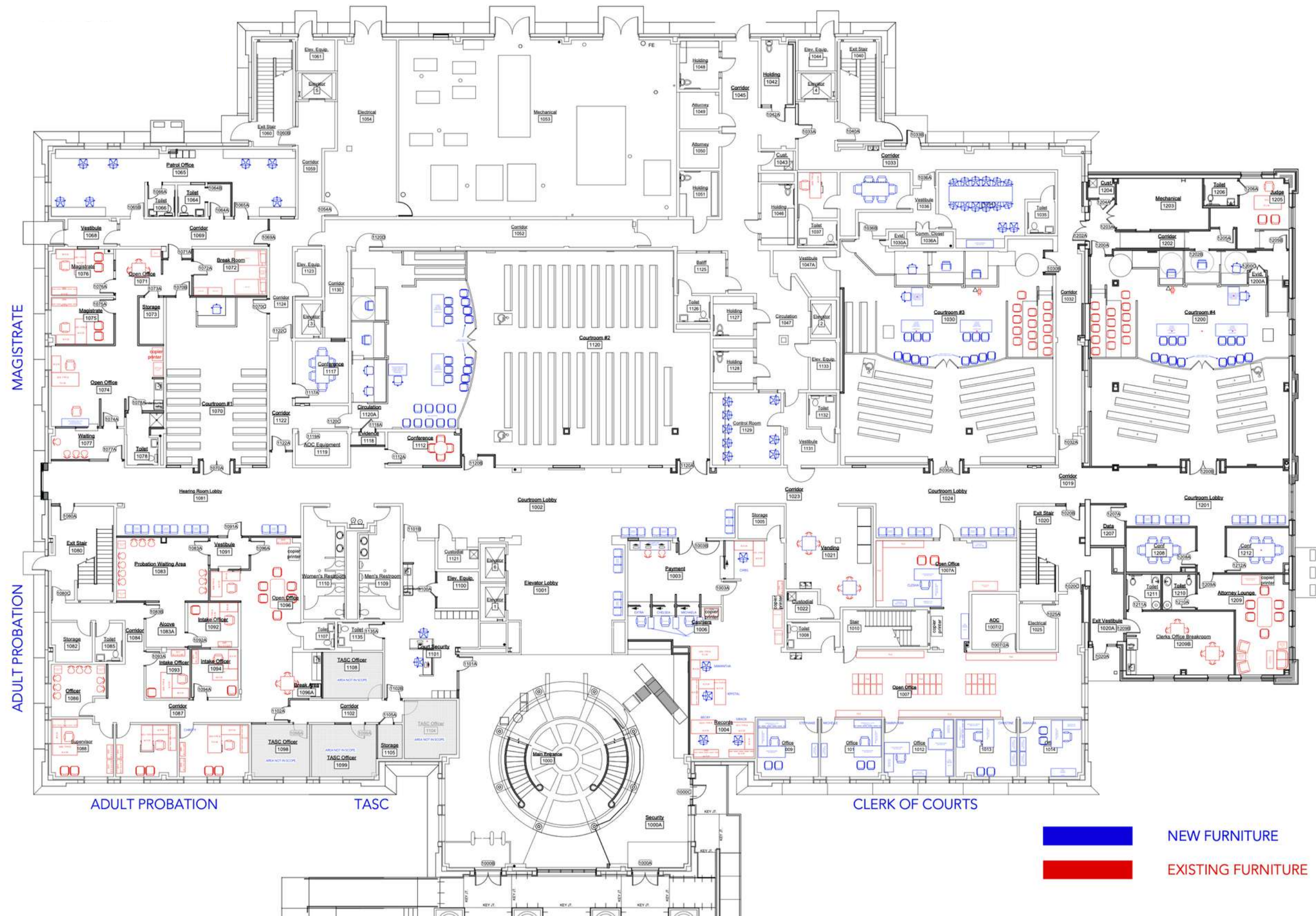

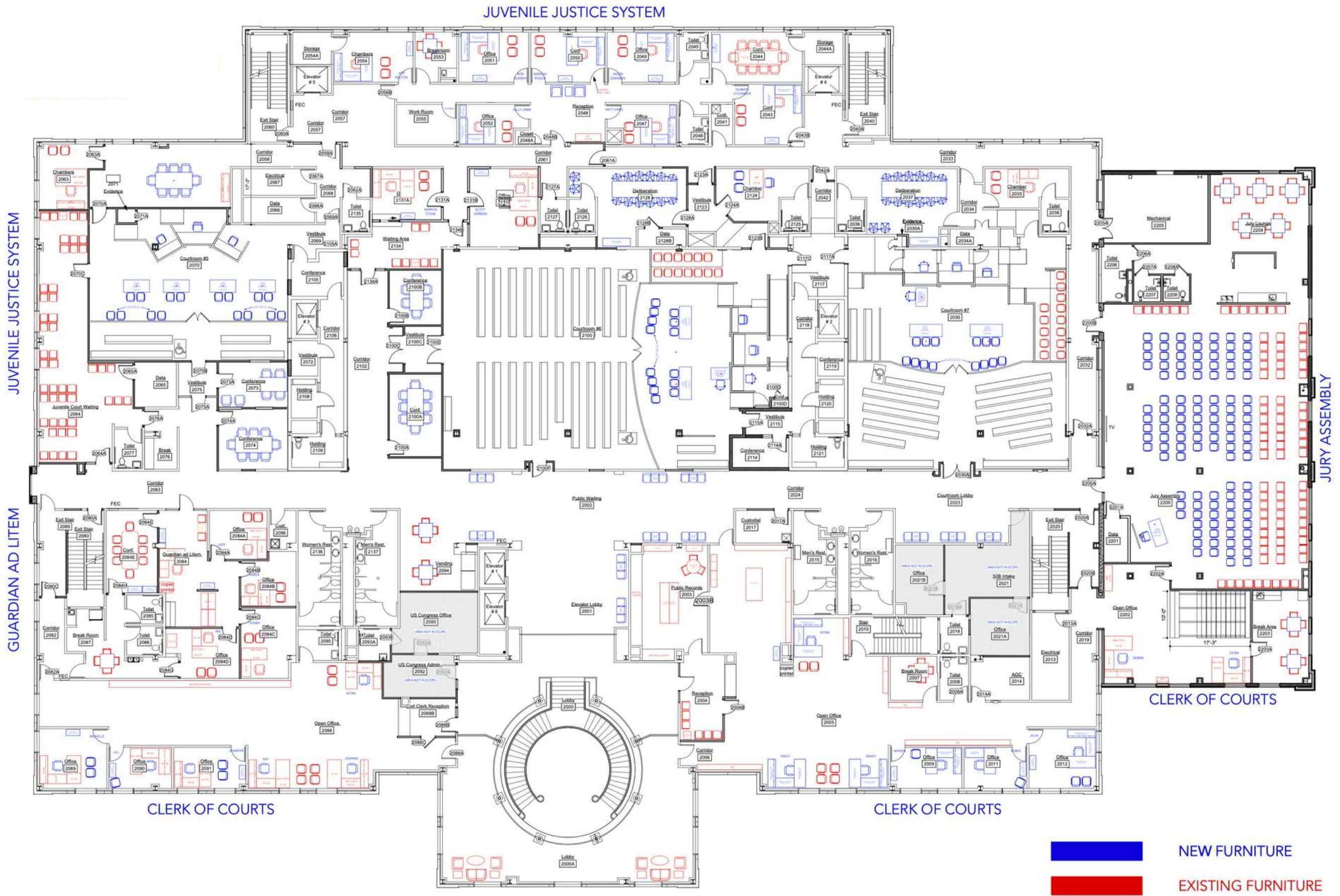

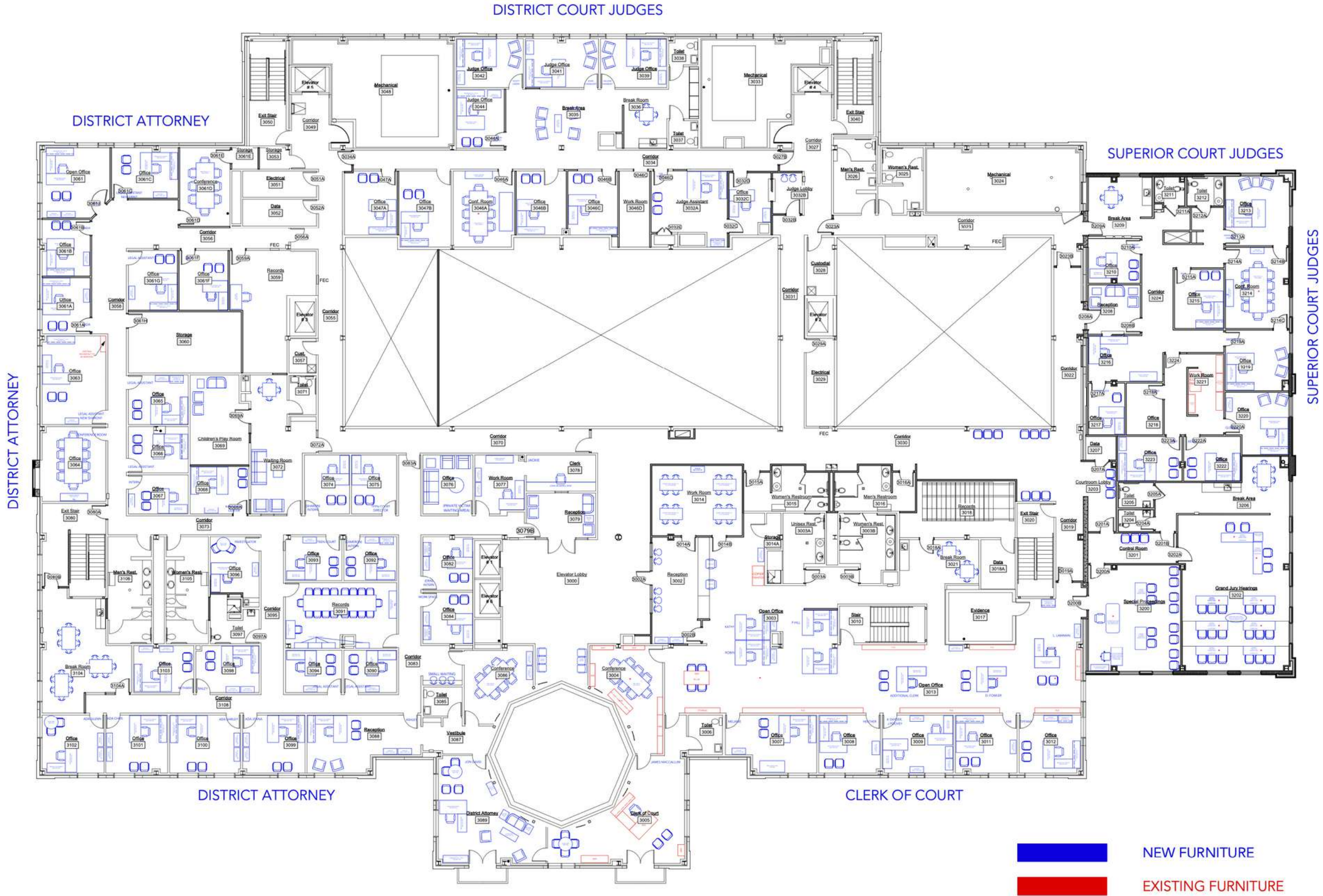

BUDGET SUMMARY- BY DEPARTMENT

CLERK OF COURTS	<i>\$ 179,281.23</i>
COURTROOMS (CONFERENCING + PUBLIC SEATING)	<i>\$127,226.84</i>
DISTRICT ATTORNEY	<i>\$234,181.82</i>
DISTRICT COURT JUDGES	<i>\$70,181.44</i>
JURY ASSEMBLY CHAIRS (114 NEW USED WITH 85 EXISTING) COST FOR ALL NEW 199 CHAIRS = \$30,665.90	<i>\$17,567.40</i>
JUVENILE JUSTICE	<i>\$65,495.48</i>
SUPERIOR COURT JUDGES	<i>\$99,199.34</i>

BUDGET SUMMARY- NEW FURNISHINGS

FIRST FLOOR	\$ 135,731.89
PUBLIC SEATING	
COURTROOMS + CONFERENCING	
ATTORNEY LOUNGE	
ADULT PROBATION	
MAGISTRATE	
CLERK OF COURTS	
SECOND FLOOR	\$ 164,190.26
PUBLIC SEATING	
COURTROOMS + CONFERENCING	
JUVENILE JUSTICE SYSTEM	
GUARDIAN AD LITEM	
CLERK OF COURTS	
JURY ASSEMBLY	
THIRD FLOOR	\$ 484,422.10
SUPERIOR COURT JUDGES	
DISTRICT COURT JUDGES	
DISTRICT ATTORNEY	
CLERK OF COURT	
GRAND JURY HEARING	
PUBLIC SEATING	
SUBTOTAL	\$ 784,344.25
ESTIMATED CONTINGENCY FOR PRICE INCREASES BETWEEN NOW AND DECEMBER 31ST, IF NEEDED	\$19,608.61
NC SALES TAX 7.25%	\$ 60,399.33
NEW FURNITURE DELIVERY, ASSEMBLY + INSTALLATION	\$ 48,750.00
EXISTING FURNITURE MOVING IN COORDINATION WITH NEW INSTALLATION AND DISPOSAL OF UNUSABLE	\$78,000.00
TOTAL	\$ 991,102.19